

## ROUES DE WAGONNET ACIER

| Ø   | G   | M  | L  | B    | A  | Charge | Roulement | Code   |
|-----|-----|----|----|------|----|--------|-----------|--------|
| 40  | 60  | 20 | 20 | 14   | 12 | 100    | 6201 RS   | 81042* |
| 50  | 62  | 32 | 32 | 26   | 15 | 600    | 6202 RS   | 81050  |
| 50  | 69  | 22 | 22 | 15,5 | 15 | 150    | 6202 RS   | 81051* |
| 60  | 79  | 26 | 26 | 20   | 17 | 200    | 6203 RS   | 81060* |
| 75  | 100 | 47 | 40 | 30   | 20 | 1200   | 6204 RS   | 81075  |
| 100 | 120 | 52 | 46 | 36   | 20 | 1200   | 6204 RS   | 81100  |
| 125 | 145 | 52 | 46 | 36   | 20 | 1200   | 6204 RS   | 81125  |
| 150 | 180 | 52 | 46 | 36   | 20 | 1200   | 6204 RS   | 81150  |
| 180 | 210 | 52 | 46 | 36   | 20 | 1200   | 6204 RS   | 81180  |
| 200 | 230 | 60 | 56 | 38   | 25 | 2000   | 6205 RS   | 81200  |
| 200 | 230 | 90 | 80 | 62   | 40 | 4000   | 6208 RS   | 81201  |
| 200 | 230 | 60 | 60 | 40   | 35 | 3000   | 6207 RS   | 81202  |
| 250 | 295 | 70 | 65 | 50   | 30 | 3500   | 6206 RS   | 81250  |
| 250 | 295 | 70 | 65 | 50   | 40 | 5000   | 6208 RS   | 81251  |
| 250 | 295 | 75 | 75 | 60   | 45 | 5000   | 6209 RS   | 81252  |
| 300 | 345 | 90 | 90 | 72   | 60 | 8000   | 6310 RS   | 81304  |

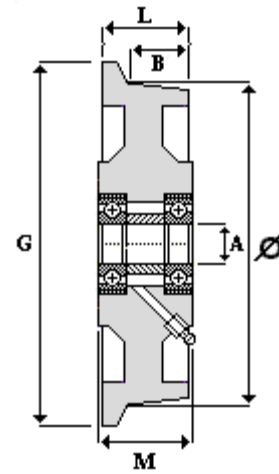

Moyeu à roulements à billes

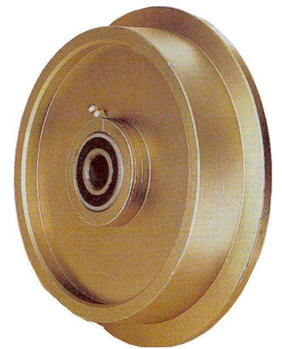

\* 1 Seul roulement

Acier C 45 bichromaté

Avec graisseur du diamètre 125 au 200 mm

## ROUES DE WAGONNET FONTE

| Ø   | G   | M  | L  | B  | A  | Charge | Code  |
|-----|-----|----|----|----|----|--------|-------|
| 50  | 62  | 32 | 32 | 26 | 15 | 600    | 83050 |
| 75  | 100 | 47 | 40 | 30 | 20 | 800    | 83075 |
| 100 | 125 | 52 | 46 | 36 | 20 | 1000   | 83100 |

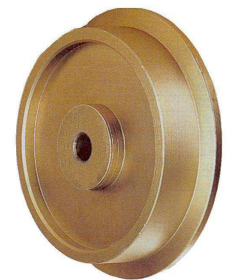
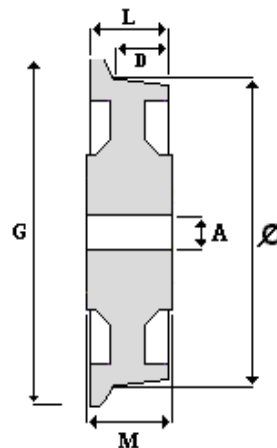

Fonte bichromatée

Moyeu lisse

